

## INSIDE PERIMETER DETAIL - 'L' TRIM

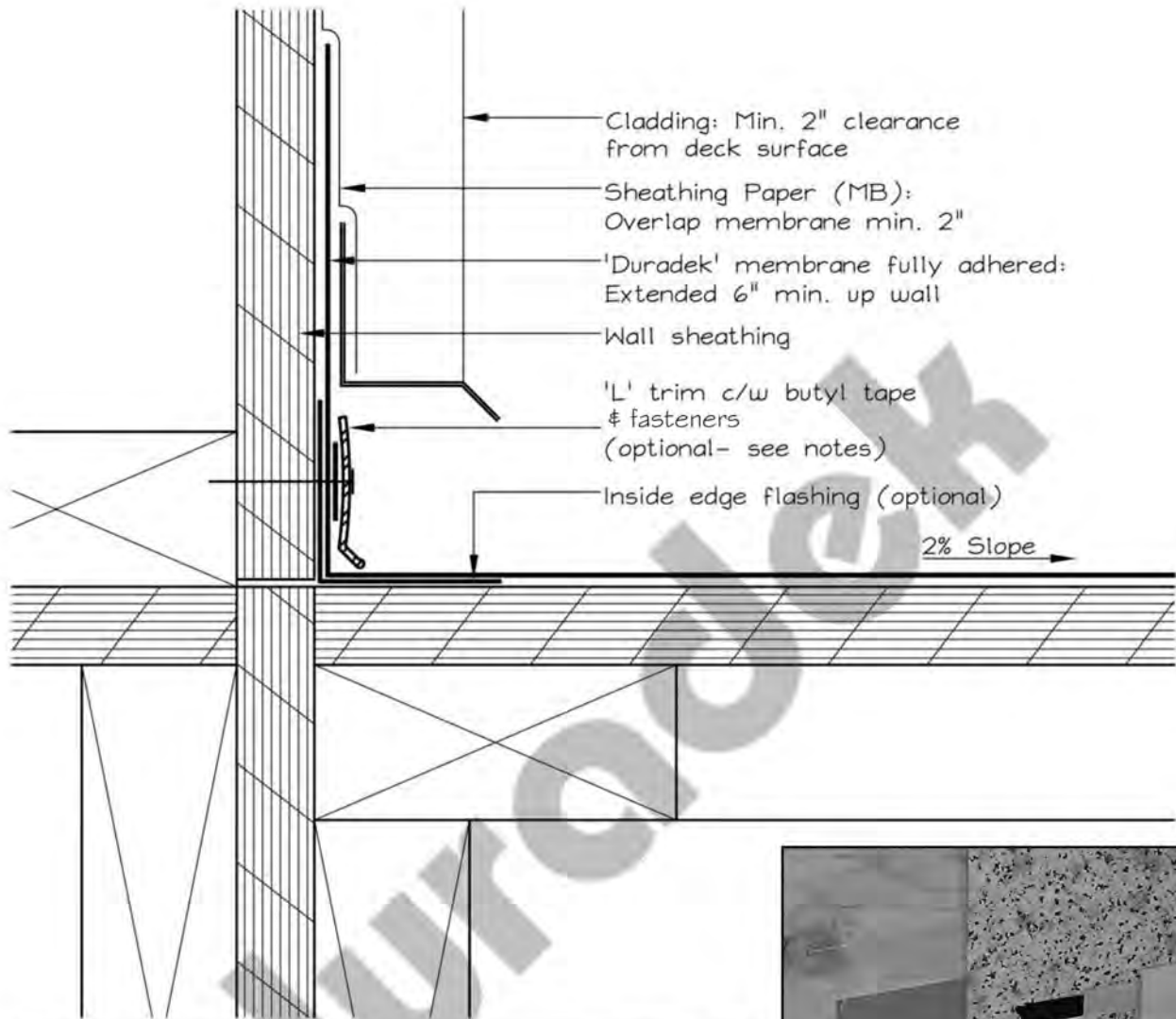

**NOTE:** 'Duradek' 'L' trim fixation bar not required if: field of membrane adhered with 'Duradek' acrylic latex adhesive, July 25% dry bulb temperature does not exceed 29 deg C. (84.2 deg F)



**NOTE:**

AS A SUPPLIER OF FINISHED PRODUCT ONLY, DURADEK DOES NOT ASSUME RESPONSIBILITY FOR ERRORS IN DESIGN, ENGINEERING, OR DIMENSIONS. THE ARCHITECT, ENGINEER, SPECIFIER, CONTRACTOR OR OWNERS' REPRESENTATIVE MUST VERIFY ALL DIMENSIONS, SIZES, AND SUITABILITY OF DETAILS, AND ARE IN ACCORDANCE WITH GOVERNING BUILDING CODES.

**DURADEK LTD.**

CANADA  
UNITED STATES

Bus: (604) 591-5594  
Bus: (816) 421-5830

Fax: (604) 591-3100  
Fax: (816) 421-2924

SYSTEM:  
ALL ASSEMBLIES

DATE: 31/08/04  
REV. DATE: 27/03/19

DRAWING No.:  
IS-01